

# Level One and Two

## Level One

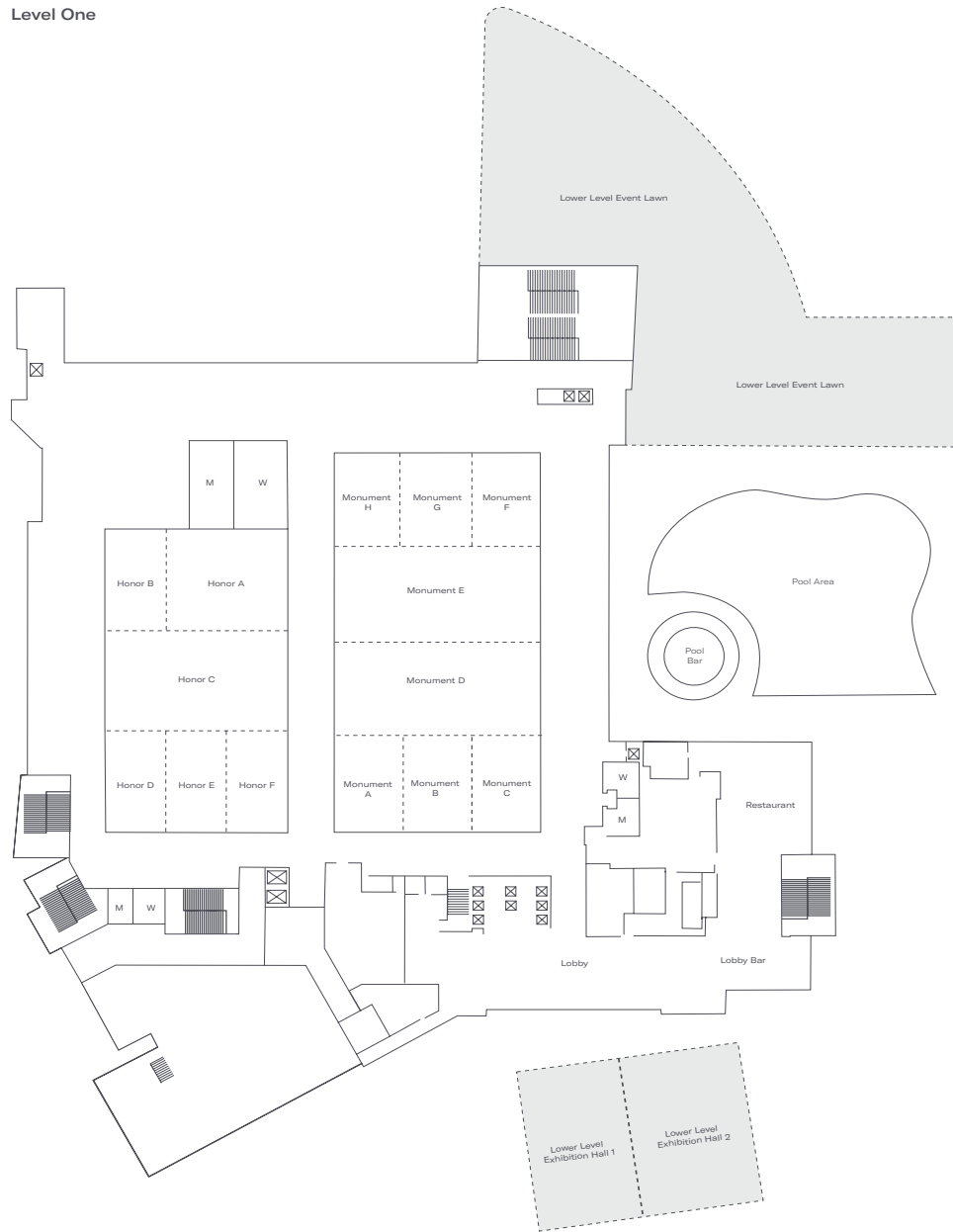

## Level Two



Venue	Dimensions (Ft.)	Sq. Ft.	Ceiling (Ft.)	Classroom	Banquet	Reception	Theater	U-Shape	Conference	Exhibits 10 x 10
<b>Lower Level</b>										
Front Row Lawn		27,228		1,815	2,269	2,723	3,025	778	648	136
Exhibition Hall 1		21,800	9'-11'	1,453	1,817	2,180	2,422	623	519	109
Exhibition Hall 2		21,469	9'-11'	1,431	1,789	2,147	2,385	613	511	107
<b>Total Exhibition Hall</b>		<b>43,269</b>		<b>2,885</b>	<b>3,606</b>	<b>4,327</b>	<b>4,808</b>	<b>1,236</b>	<b>1,030</b>	<b>216</b>
<b>Total Lower Level</b>		<b>70,497</b>		<b>4,700</b>	<b>5,875</b>	<b>7,050</b>	<b>7,833</b>	<b>2,014</b>	<b>1,679</b>	<b>352</b>
<b>Level One</b>										
Honor Ballroom A	62'-2" x 70'-3"	4,371	27'	291	364	437	486	125	104	22
Honor Ballroom B	62'-2" x 35'-2"	2,185	27'	146	182	219	243	62	52	11
Honor Ballroom C	61'-10" x 105'-9"	6,547	27'	436	546	655	727	187	156	33
Honor Ballroom D	62'-7" x 35'-7"	2,182	27'	145	182	218	242	62	52	11
Honor Ballroom E	62'-7" x 35'-7"	2,182	27'	145	182	218	242	62	52	11
Honor Ballroom F	62'-7" x 35'-7"	2,182	27'	145	182	218	242	62	52	11
<b>Total Honor Ballroom</b>		<b>19,649</b>		<b>1,310</b>	<b>1,637</b>	<b>1,965</b>	<b>2,183</b>	<b>561</b>	<b>468</b>	<b>98</b>
Monument Ballroom A	57'-7" x 40'-6"	2,333	27'	156	194	233	259	67	56	12
Monument Ballroom B	57'-7" x 40'-6"	2,333	27'	156	194	233	259	67	56	12
Monument Ballroom C	57'-7" x 40'-6"	2,333	27'	156	194	233	259	67	56	12
Monument Ballroom D	57'-11" x 121'-6"	7,008	27'	467	584	701	779	200	167	35
Monument Ballroom E	57'-11" x 121'-6"	7,008	27'	467	584	701	779	200	167	35
Monument Ballroom F	57'-7" x 40'-6"	2,333	27'	156	194	233	259	67	56	12
Monument Ballroom G	57'-7" x 40'-6"	2,333	27'	156	194	233	259	67	56	12
Monument Ballroom H	57'-7" x 40'-6"	2,333	27'	156	194	233	259	67	56	12
<b>Total Monument Ballroom</b>		<b>28,014</b>		<b>1,868</b>	<b>2,335</b>	<b>2,801</b>	<b>3,113</b>	<b>800</b>	<b>667</b>	<b>140</b>
<b>Total Level One</b>		<b>47,663</b>		<b>3,178</b>	<b>3,972</b>	<b>4,766</b>	<b>5,296</b>	<b>1,362</b>	<b>1,135</b>	<b>238</b>
<b>Level Two</b>										
Beautyberry	32'-4" x 19'-5"	626	13' 4"	42	52	63	70	18	15	3
Big Bend	32'-4" x 20'-2"	651	13' 4"	43	54	65	72	19	16	3
Bluebonnet	26'-9" x 14'-3"	372	13' 4"	25	31	37	41	11	9	2
Cenizo	24'-9" x 41'-1"	1,017	13' 4"	68	85	102	113	29	24	5
Dolomite	62'-0" x 35'-2"	2,177	13' 4"	145	181	218	242	62	52	11
Limestone	40'-6" x 25'	1,013	13' 4"	68	84	101	113	29	24	5
Lupine A	25' x 41'-2"	1,032	13' 4"	69	86	103	115	29	25	5
Lupine B	25' x 41'-2"	1,032	13' 4"	69	86	103	115	29	25	5
Lupine C	24' x 41'-2"	1,020	13' 4"	68	85	102	113	29	24	5
Mockingbird	44'-4" x 25'	1,108	13' 4"	74	92	111	123	32	26	6
Pavonia	42'-5" x 25'	1,061	13' 4"	71	88	106	118	30	25	5
Pecan	40'-6" x 25'	1,012	13' 4"	67	84	101	112	29	24	5
Post Oak A	34'-9" x 25'	868	13' 4"	58	72	87	96	25	21	4
Post Oak B	36'-6" x 25'	913	13' 4"	61	76	91	101	26	22	5
Post Oak C	38'-7" x 25'	965	13' 4"	64	80	97	107	28	23	5
Rock Rose	26' x 23'-7"	616	13' 4"	41	51	62	68	18	15	3
Sage A	57' x 46'-0"	2,398	13' 4"	160	200	240	266	69	57	12
Sage B	57' x 36'-0"	1,860	13' 4"	124	155	186	207	53	44	9
Sandstone	68'-6" x 32'-6"	2,228	13' 4"	149	186	223	248	64	53	11
Shale	30'-3" x 24'	728	13' 4"	49	61	73	81	21	17	4
<b>Total Level Two</b>		<b>22,697</b>		<b>1,513</b>	<b>1,891</b>	<b>2,270</b>	<b>2,522</b>	<b>648</b>	<b>540</b>	<b>113</b>

# Level Three and Four

Level Three

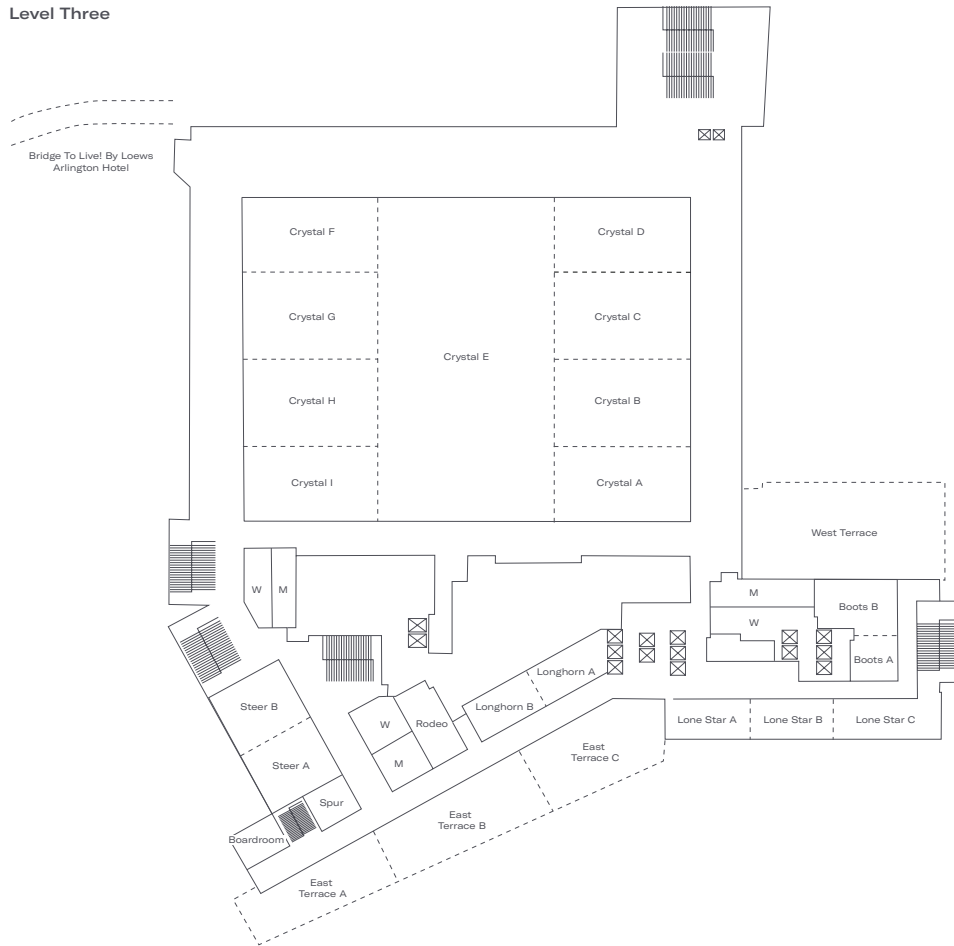

Level Four

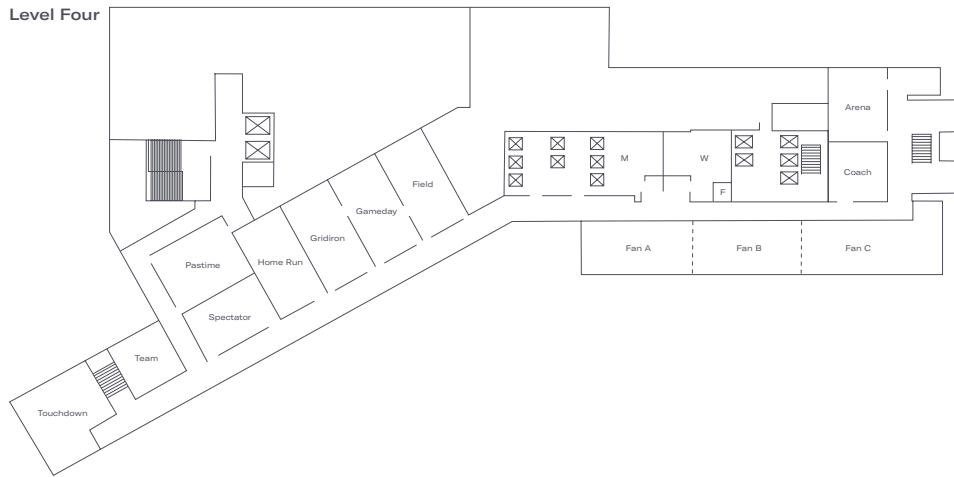

Venue	Dimensions (Ft.)	Sq. Ft.	Ceiling (Ft.)	Classroom	Banquet	Reception	Theater	U-Shape	Conference	Exhibits 10 x 10
<b>Level Three Exterior Event Terrace</b>										
West Terrace	104' x 56' 2"	5,808		387	484	581				
East Terrace A	33' x 75'	2,811	27'	160	200	240				
East Terrace B	36' x 82'	2,973	27'	170	213	255				
East Terrace C	39' x 96'	4,229	27'	105	132	158				
<b>Total Event Terrace</b>		<b>12,848</b>		<b>950</b>	<b>1,188</b>	<b>1,425</b>				

Venue	Dimensions (Ft.)	Sq. Ft.	Ceiling (Ft.)	Classroom	Banquet	Reception	Theater	U-Shape	Conference	Exhibits 10 x 10
<b>Level Three</b>										
Crystal Ballroom A	74' 4" x 45' 6"	3,525	23'	235	294	353	392	101	84	18
Crystal Ballroom B	74' 4" x 52' 6"	4,087	23'	272	341	409	454	117	97	20
Crystal Ballroom C	74' 4" x 52' 6"	4,087	23'	272	341	409	454	117	97	20
Crystal Ballroom D	74' 4" x 45' 6"	3,525	23'	235	294	353	392	101	84	18
Crystal Ballroom E	196' x 106'	20,776	23'	1,385	1,731	2,078	2,308	594	495	104
Crystal Ballroom F	74' 4" x 45' 6"	3,525	23'	235	294	353	392	101	84	18
Crystal Ballroom G	74' 4" x 52' 6"	4,087	23'	272	341	409	454	117	97	20
Crystal Ballroom H	74' 4" x 52' 6"	4,087	23'	272	341	409	454	117	97	20
Crystal Ballroom I	74' 4" x 45' 6"	3,525	23'	235	294	353	392	101	84	18
<b>Total Crystal Ballroom</b>		<b>51,224</b>		<b>3,415</b>	<b>4,269</b>	<b>5,122</b>	<b>5,692</b>	<b>1,464</b>	<b>1,220</b>	<b>256</b>
<b>Boardroom</b>									<b>16</b>	
Boots A	28' x 26'	663	13' 4"	44	55	66	74	19	16	3
Boots B	49' 1 x 26'	1,435	13' 4"	96	120	144	159	41	34	7
Lone Star A	51' x 23'	1,104	13' 4"	74	92	110	123	32	26	6
Lone Star B	50' x 23'	1,075	13' 4"	72	90	108	119	31	26	5
Lone Star C	64' x 23'	1,542	13' 4"	103	129	154	171	44	37	8
Longhorn A	47' x 20' 6"	970	13' 4"	65	81	97	108	28	23	5
Longhorn B	43' x 20' 6"	853	13' 4"	57	71	85	95	24	20	4
Rodeo	45' 4" x 23'	1,045	13' 4"	70	87	105	116	30	25	5
Spur	23' x 21' 3"	490	13' 4"	33	41	49	54	14	12	2
Steer A	43' x 39'	1,634	13' 4"	109	136	163	182	47	39	8
Steer B	43' x 39' 2"	1,680	13' 4"	112	140	168	187	48	40	8
<b>Total Meeting Rooms</b>		<b>13,158</b>		<b>877</b>	<b>1,097</b>	<b>1,316</b>	<b>1,462</b>	<b>376</b>	<b>313</b>	<b>66</b>
<b>Total Level Three</b>		<b>78,634</b>		<b>5,242</b>	<b>6,553</b>	<b>7,863</b>	<b>8,737</b>	<b>2,247</b>	<b>1,872</b>	<b>393</b>
<b>Level Four</b>										
Arena	33' x 25'	1,193	13' 4"	80	99	119	133	34	28	6
Coach	25' 6" x 25'	1,037	13' 4"	69	86	104	115	30	25	5
Fan A	50' x 24'	1,086	13' 4"	72	91	109	121	31	26	5
Fan B	48' x 24'	1,047	13' 4"	70	87	105	116	30	25	5
Fan C	67' x 24'	1,047	13' 4"	70	87	105	116	30	25	5
Field	45' x 23' 4"	824	13' 4"	55	69	82	92	24	20	4
Gameday	45' x 24'	1,051	13' 4"	70	88	105	117	30	25	5
Gridiron	45' x 24'	639	13' 4"	43	53	64	71	18	15	3
Home Run	45' x 24' 6"	825	13' 4"	55	69	83	92	24	20	4
Pastime	36' x 29'	1,630	13' 4"	109	136	163	181	47	39	8
Spectator	36' x 23'	640	13' 4"	43	53	64	71	18	15	3
Team	29' x 25'	1,155	13' 4"	77	96	116	128	33	28	6
Touchdown	39' x 24' 8"	1,347	13' 4"	90	112	135	150	38	32	7
<b>Total Level Four</b>		<b>13,943</b>		<b>930</b>	<b>1,162</b>	<b>1,394</b>	<b>1,549</b>	<b>398</b>	<b>332</b>	<b>70</b>